



Canteen / Cafeteria Solution

About:

SAVIOR offers a Hardware and Software based comprehensive solution for Canteen / Cafeteria Solution (CCS) which is ideal for –

- Large Corporate In-house Canteen / Cafeteria
- Independently run Canteen / Mess / Cafeteria in
 - Government Buildings
 - BPO's / Call Centers
 - Universities / Institutions.
- Any other

How does it work?

SAVIOR CCS works either linked with the SAVIOR Time and Attendance systems (ideal for employees using corporate canteens) or as an Independent Canteen module.

SAVIOR Readers (Smartcard / Fingerprint / Biometric based) are installed where employees / Visitors / guest / users will record the Canteen facility used / consumed and this data is linked to PC for generation of reports / employee deductions.

SAVIOR can also provide Point based Independent CCS (ideal for cafeterias run by contractors where use is based on pay per use or coupon systems, where there is no link to or deduction from salary. Users can be given Smart Cards with points which can be redeemed against facilities used in the Canteens / Cafeterias etc.

Users can recharge their smart cards at the recharge points provided at authorized counter within the Canteen.

Features:

- Smart Card / Smart Card + Biometric / Biometric based solutions.
- Multi Canteen handling.
- Suitable for Corporate and Independent Canteens.
- Time Office / Payroll linked solution.
- Can be used during predefined Lunch / Dinner / Tea / Snacks time.
- Provision for Guest / Visitor.
- Point Based solution.

Tel +91 11 49816000, email – sales@saviorstj.com website - www.saviorstj.com

Copyright © STJ Electronics P Ltd – 2011



Canteen / Cafeteria Solution

- Any time usable model.
- Flexible item menu to choose from.
- Coupon printing (optional).
- Consumption / Sales reports.

Components of the Solution:

1. Smart Card / Finger print reader
2. Smart cards
3. Printer
4. IP Address / Cabling
5. CCS Software
6. Communication / Data collection interface software

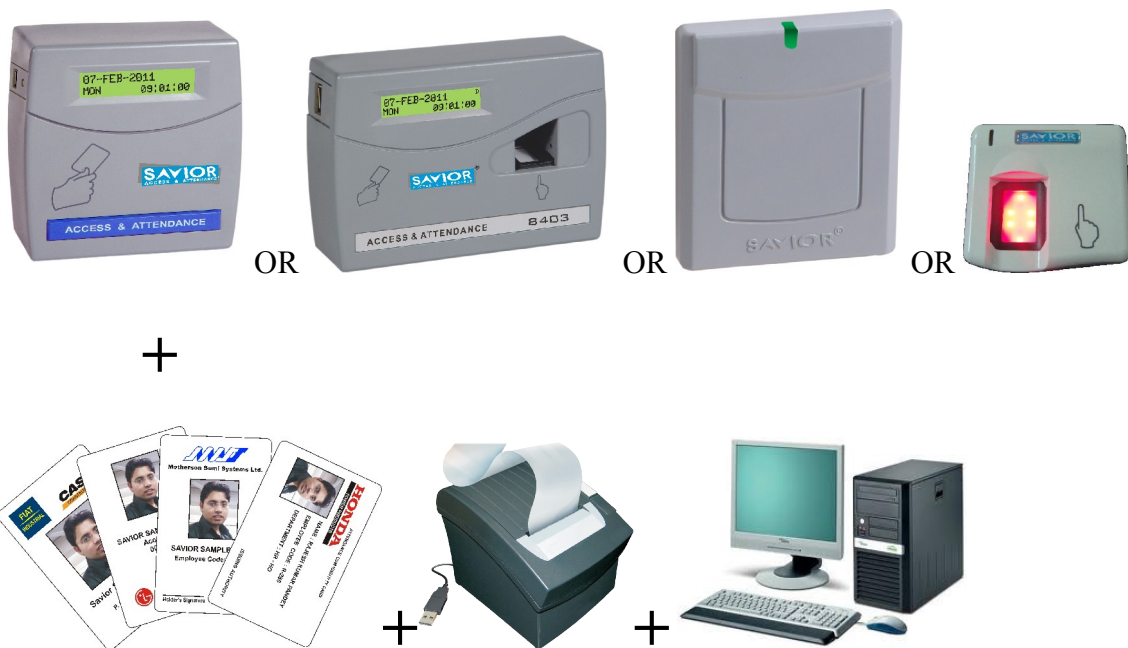



Canteen / Cafeteria Solution

Key Reports:

- Total Consumption (daily / monthly) with Canteen wise break up.
- Employee wise consumption (if linked with SAVIOR TOS)
- Date wise + Shift wise consumption (if linked with SAVIOR TOS)
- Extra consumption report.

SAVIOR Role (One Stop Shop):

1. Understand client requirements
2. Customization (Hardware / Software (If any))
3. Supply and Install Hardware / Software
4. Design / Print / Supply Smartcards
5. Configure solution
6. Train employees / users
7. Support and service solution

Reach Us:

Please contact SAVIOR sales team for demo / Performa Invoice / any other / Client references / details.